



YETI SB150 PROTECTIVE DECAL APPLICATION

SB150 DECAL PROTECTOR KIT PLACEMENT INSTRUCTIONS

This guide is intended to give you the approximate placements for your decal protector kit. Some modification may be necessary when applying to assembled bikes. If you are not starting with a new bike you will want to thoroughly clean your bike before beginning this process.

Work in a clean dry place with space. Minimize your contact with the adhesive surfaces. Clean your hands thoroughly and lay out your decals.

*Dirty hands result in discoloration that will be permanent and visible.

Adding a little heat will help you in applying the decals to complex shapes and curves. Have your hair dryer or heat gun at the ready. Be sure you use low heat and do not hold the heat on the decal or the frame too long. Overheating will result in discoloring and deforming of the decal.

***CAUTION:** Excessive heat can damage your decals and potentially damage your carbon frame. Any damage to caused by improper installation of the protector decals will not be covered by warranty.

WHAT YOU WILL NEED TO GET STARTED:

- _____ LINT FREE RAG
- _____ RUBBING ALCOHOL
- _____ HAIR DRYER/HEAT GUN
- _____ CLEAN BIKE
- _____ CLEAN HANDS
- _____ MEASURING DEVICE

***NOTE:** Feel free to cut out any custom shapes you might want using the remaining decal scraps. Get creative!

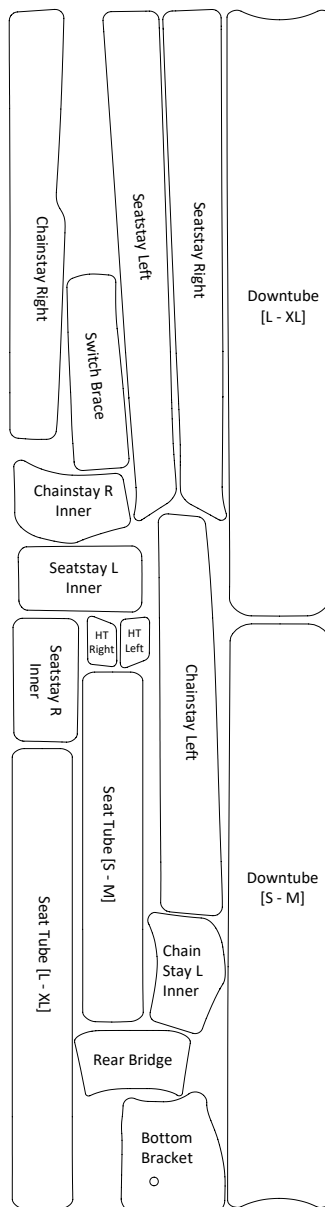

DOWN TUBE PROTECTOR:

Place the lower end of the down tube protector decal the rubber protector. Starting at the bottom, stick the center of the decal onto the down tube all the way to upper end. Grab your heat gun and lightly heat the decal in the area you are working. Work from the centerline out to the edges sticking the decal down.

***NOTE:** There are two DT protector sizes. Use the correct one for your frame size! Short for SM-MD, Long for LG-XL.

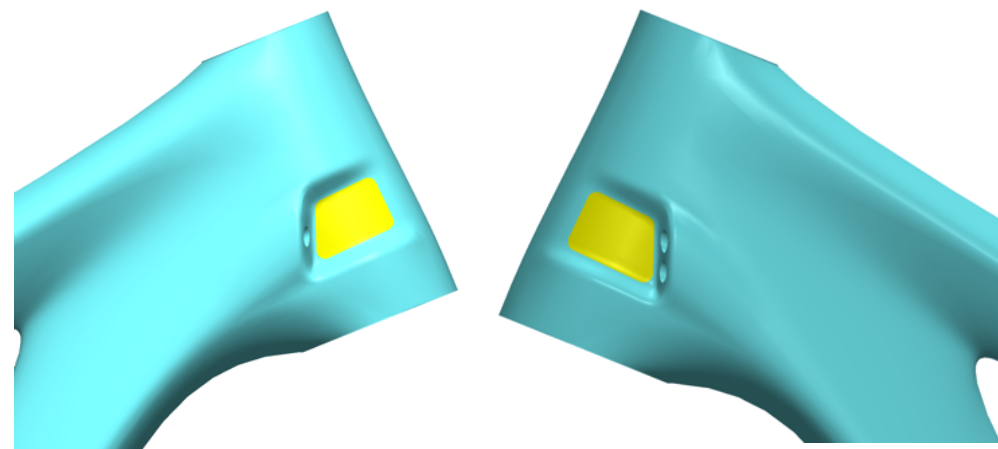

HEAD TUBE CABLE RUB PROTECTOR:

Place one protector on either side of the head tube to prevent cable rub.

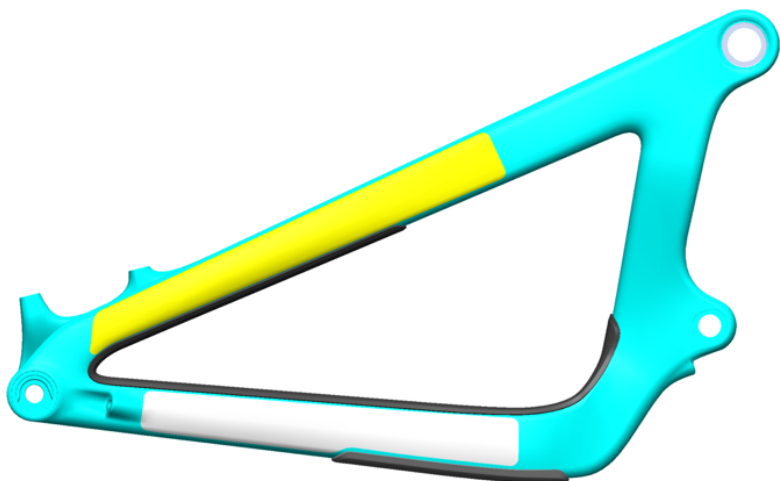

SEAT STAY PROTECTOR:

Apply Seat Stay decals spaced 180mm from the center of the Seat Stay Pivot Bolt
Repeat for opposite side.

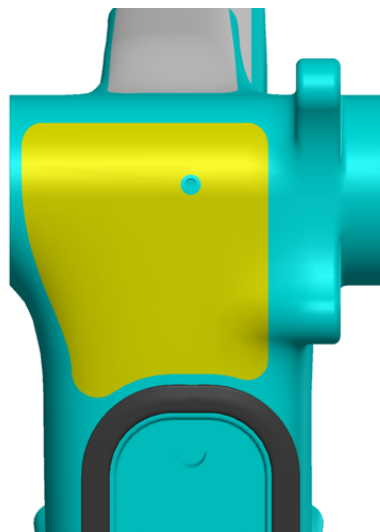

BOTTOM BRACKET PROTECTOR:

Place BB Decal around the drain hole, aligning the curve around the Down Tube protector.

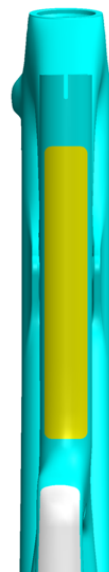

SEAT TUBE PROTECTOR:

Place the Seat Tube decal at the start of the bend between the Seat Tube and Switch Infinity Brace.
***NOTE:** There are two ST protector sizes. Use the correct one for your frame size. Short for SM-MD, Long for LG-XL.

LEFT

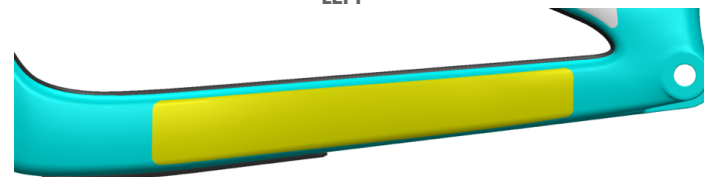

RIGHT

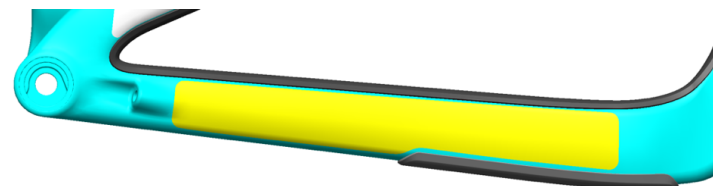

LEFT AND RIGHT CHAIN STAY PROTECTORS:

(Left) Place the Left Chainstay Decal 62mm from the center of the rear axle.

(Right) Place Decal such that it sits within the curves of the rubber Chainstay Protectors.

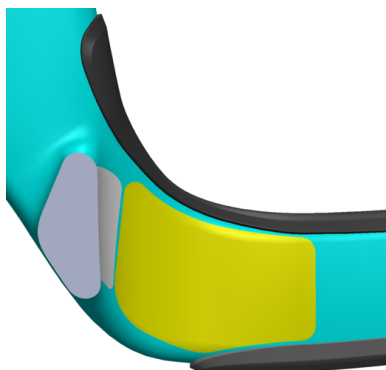

CHAIN STAY INNER PROTECTOR (RIGHT):

Place the Inner Brace Right Decal as shown such that it fits within the rubber swingarm protectors.

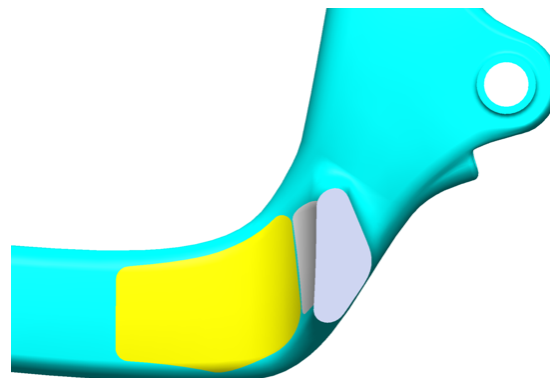

CHAIN STAY INNER PROTECTOR (LEFT):

Place the Left CS Inner decal as shown, lining up the edges of this decal and the RT Bridge Decal

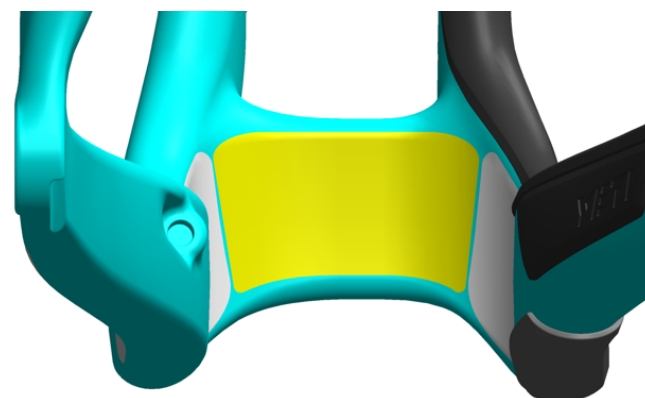

REAR TRIANGLE BRIDGE PROTECTOR:

Place the RT Bridge decal as shown, spaced evenly up/down on the swingarm surface.

Align the right edge with the Right CS Inner Decal

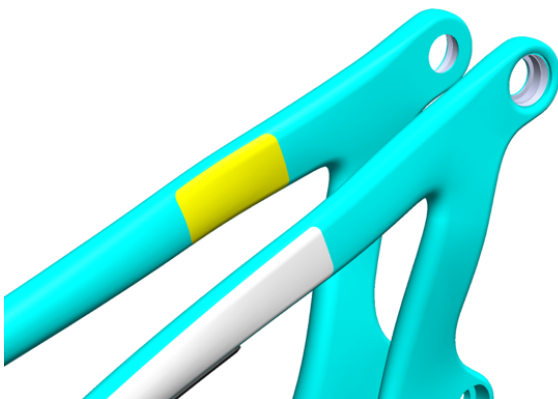

SEAT STAY INNER PROTECTORS:

Place the Left CS Inner decal as shown, lining up the edges of this decal and the RT Bridge Decal

NOW THAT YOUR BIKE IS CLEAN AND PROTECTED, GO OUT AND GET IT DIRTY!

If you have any questions related to your protector decals or any other part of your bike please feel free to drop us a line any time. We are always happy to help!

yeticycles.com/support
service@yeticycles.com

YETI CYCLES

621 Corporate Circle, Unit B
 Golden, CO 80401
 (p) 303-278-6909

BUSINESS HOURS

Monday-Friday
 8AM-11:30AM, 1:00PM-5:30PM
 (Mountain Time)